

Louisburg Speaks ^{KS}

inside this issue:

- Know a gas leak
- History Hunt
- Ward maps
- Mayor's Minute
- Calendar

April-May 2023

Leaf survey results are in

Eighty-one respondents answered the leaf survey that appeared in the last issue of Louisburg Speaks.

City Council members learned the results at the March 20 council meeting. Since that meeting a few more surveys have been submitted.

While the survey was discussed at the meeting, Council members did not make any decisions about leaf collection inside the city limits or making any additional changes to the brush dump operations.

While most respondents indicate they don't burn leaves at their residence (48 vs 29), a majority are in favor of allowing for leaf burning (52 vs 27).

Most respondents said they mulch their leaves (41), followed by hauling off (37) and then burning on their property (30).

When asked to rank their preferred method of disposing of leaves, the top three responses were almost identical: hauling off (24) and mulching and burning (tied at 22).

Not all respondents answered all questions but for those that did, 31 lived in Ward 1, 14 in Ward 2, 17 in Ward 3 and 15 in Ward 4.

The entire leaf survey can be found on the Public Works department page on the City's website.

Hometown Hero banners to be renewed, go on sale

Hometown Hero banners will soon be flying in downtown Louisburg for Memorial Day.

The banners honor those Miami County residents who have served in the country's military.

Biographies of each of the honorees can be found on the Chamber of Commerce's website: www.louisburgkansas.com/hometown-heroes/.

This Memorial Day will be the last time the current banners will fly. Banner purchasers will be given the option to purchase new banners. Banners only hang for two years because of the abuse they take from the Kansas sun and winds.

Current banner purchasers will be contacted in the next few weeks with the option to renew their banner. If not all banners are renewed, then banners will be opened up to new honorees.

The City and American Legion Auxiliary are looking at adding banner brackets to light poles along S. Metcalf to be able to offer additional banner spaces.

Banners are displayed in the weeks before and after Memorial and Veterans days.

Watch the City's website and Facebook for information on additional banner sales in early June.

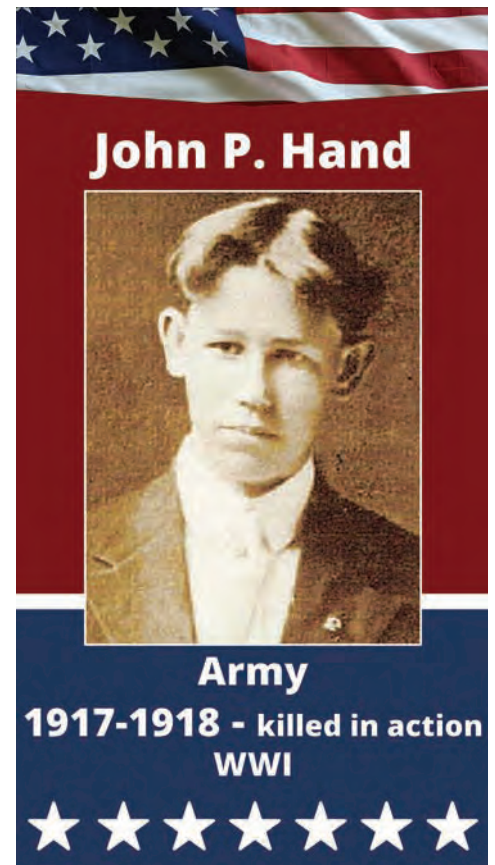

This Hometown Heroes banner honors John P. Hand, the first Louisburg area resident killed during World War I and for whom the local American Legion chapter is named.



Mayor

Donna Cook
dcook@louisburgkansas.gov

Ward 1

Scott Margrave
smargrave@louisburgkansas.gov

Ward 2

Tiffany Ellison
t Ellison@louisburgkansas.gov

Ward 3

Clint Ernst
cernst@louisburgkansas.gov

Ward 4

TJ Williams
twilliams@louisburgkansas.gov

At-Large

Steve Town
stown@louisburgkansas.gov

City Hall

Nathan Law
City Administrator
215 S. Broadway
Louisburg, KS 66053
913-837-5371
www.louisburgkansas.gov
Hours: 7 am - 4:30 pm
Monday-Friday

Police Department

Chief Josh Weber
209 S. Metcalf Rd.
Louisburg, KS 66053
913-837-3191

Fire Department

Chief Gerald Rittinghouse
205 S. Metcalf Rd.
Louisburg, KS 66053
913-837-4700

Louisburg Speaks is published six times a year by the City of Louisburg for its residents. Please direct questions or comments to jcarder@louisburgkansas.gov

The City of Louisburg requires building permits. Please call the Building & Zoning Department at 913-837-5811 before beginning any construction project.

Know the warning signs of a gas leak

Summer is almost here and more people will be outside enjoying outdoor activities in their yards, neighborhoods and parks.

While Louisburg's natural gas system is regularly inspected, it's always a good idea to learn the warning signs of a gas leak as a leak could happen in your home or yard.

Gas leaks can occur due to an accident, digging without requesting utilities to be located via Kansas Dig Safe and sometimes old fittings and valves

can just become old and wear out.

An additive that smells like rotten eggs is put into natural gas since in its natural state, gas has no odor.

Other signs of a gas leak are hissing sounds, discolored or dead grass/plants, bubbling water in wet or flooded areas and dirt or dust blowing from a hole in the ground

If you suspect a leak, leave the area immediately. Do not use an electrical device like a cell or landline phone, light switches or garage door openers. Do

not start your car. Do not try to shut off the gas valves to appliances or try and find the leak. When you get to a safe area away from the leak, call 911.



COURTESY KANSAS CORPORATION COMMISSION

MAYOR'S MINUTE

Become involved in your community

In like a lion, out like a lamb for March and April showers bring May flowers, as the saying goes. As I write this, I think March came in like a lion and out like one, also. April started out with showers and there are always lovely flowers popping up March thru May.

In the last newsletter, I mentioned future growth. I just want to keep everyone thinking about it. As citizens, we all need to get involved in what we want our city to look like for the future. Please, come to our council meetings or reach out to your council person, so your voices can be heard. I know I hear the same comments; no one will listen so why voice any comments. We as the city need your constructive ideas to help us grow and fix some of our issues we have going on. I was approached by a constituent to start the Coffee with the Mayor up again. So by the time

you read this hopefully it will be up and going. I know I can't answer all questions; however, I can bring your ideas/comments to the attention of your governing body.

Property taxes are what everyone is talking about. It is the budgets that set the mill levy. Not only the city, but the county, library, and school district budgets weigh into your taxes. So please be involved in all aspects of your community. It takes the voices of our community to keep us on the right track.

Have a great summer. So looking forward to my first tomato and wilted lettuce.



DONNA COOK



Clues like these will be a part of the Louisburg History Hunt coming in May sponsored by the Louisburg Historic Preservation Commission.

Celebrate Louisburg with History Hunt

Calling all history buffs and those that just like a good mystery. The Louisburg Historic Preservation Commission has an activity for all ages in May.

May is Historic Preservation Month and the local commission wants you out looking high and low to unlock the mysteries to Louisburg's past. The commission is sponsoring a scavenger hunt of architectural features in — and within a block— of the historic downtown.

The game is afoot starting May 1 with the contest ending at 4:30 p.m. Wednesday, May 31. The winner will be determined by a drawing from all correct entries and will be an-

nounced at the June meeting of the Historic Preservation Commission. The winner will also receive a prize.

Contestants can print a copy of the entry form from the City's website starting May 1 or may pick up a copy at City Hall during regular business hours.

When the contest is over the buildings and their history will be shared on the City's website and Facebook page.

The commission has several other activities planned for this year including a Lunch and Learn this summer with a guest speaker, a Citizens Academy in August and a Talking Tombstones event in October.

Drug Take-Back Day April 22

The semi-annual DEA Drug Take-Back Day is set for 10 a.m. to 2 p.m. Saturday, April 22 at the Louisburg Police Station, 209 S. Metcalf Road.

Area residents may bring their unused or outdated medications to the drop off in the parking lot in front of the station, which will be monitored by a local officer.

The service is free and is anonymous. According to information from the DEA, unused or expired medications are a public safety issue and can lead to accidental poisoning, misuse or overdose.

For more information, including how to dispose of unwanted medications if you can't attend the event, can be found on the City's website.

Louisburg Aquatic Center readies for opening

The pool is getting a new paint job for opening day at noon, Saturday, May 27.

Pool passes are available to purchase through the LAC Marketplace with a link to purchase on the City's website: www.louisburgkansas.gov. This year's pass price will be \$30.

Daily admission is \$4. A 10-day punch pass is available for \$30.

For more information on the Aquatic Center and swim lessons conducted by the Louisburg Barracuda swim team,

check the LAC's department page on the City's website.

AQUATIC CENTER FACEBOOK PAGE

There is a City-sponsored Facebook page for the pool at www.facebook.com/Louisburgpool. Watch that page during pool season for updates on early closures, weather events and other pool news.

Citywide clean-up

City residents may clean out the closet, garage, basement or shed and dispose of non-regular trash during citywide clean-up Saturday, April 29. All items should be placed at the curb by 6:30 a.m.

White good items will be picked up by the City's Public Works crews with other trash being picked up by the trash contractor. Yard waste and hazardous items will not be picked up.

Cemetery clean-up

Persons who have extra mementos at graves in the Louisburg Cemetery and would like to keep those items should plan to pick them up before Saturday, May 7. Members of the LHS National Honor Society will be making a sweep of the cemetery picking up loose items around graves and trash in preparation for Memorial Day. Any artificial flowers will be disposed of unless they are located in vases that are part of a monument.

Brush dump closed

There will be times the brush dump will be closed due to the amount of brush and the ability of staff to sort and burn the material to follow KDHE requirements. Notification will be posted on the City's website and Facebook on Wednesdays if the dump will be closed that weekend.

Upcoming summer fun

Mark your calendars for two upcoming fun summer family activities.

The annual Fishing Derby will be Saturday, June 17 at Ron Weers Park. Registration starts at 7 a.m. with fishing from 8-10 a.m. Those attending can enjoy a hot dog lunch followed by prize distribution for most fish, biggest fish and total inches caught in five age divisions. Anglers under 16 may participate. Bring your own pole and bucket. Hooks, worms and bobbers are provided.

Freedom Fest is Tuesday, July 4 at Lewis-Young Park. Enjoy music and activities in the park followed by a fireworks show at dusk. Businesses and organizations are invited to have a booth. The event starts at 6 p.m. Watch for more details.

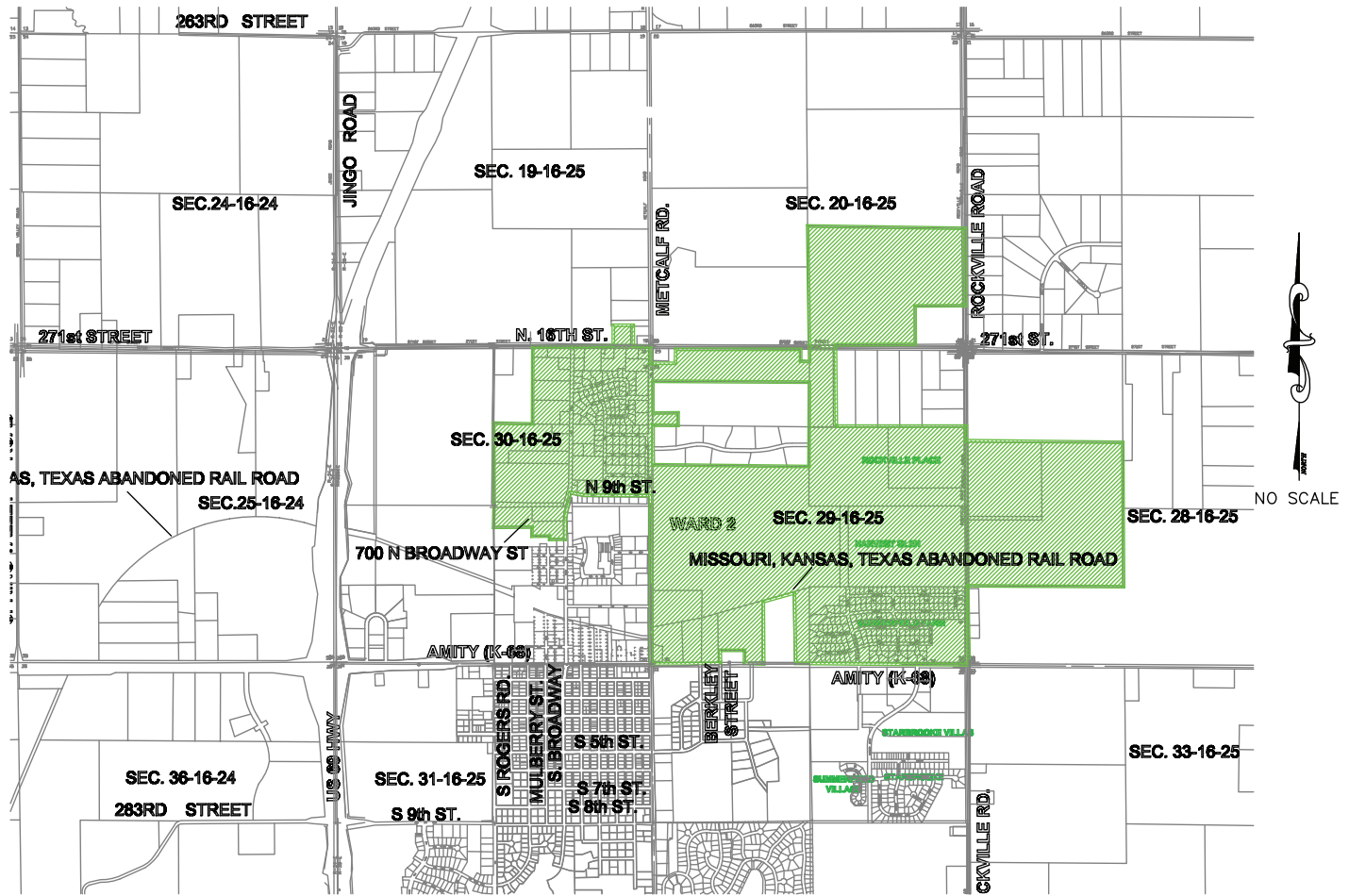

Ward 2 map

In response to a request by a resident, ward maps will be published in the next few issues of Louisburg Speaks. This image shows the boundaries of Ward 2. All ward maps may be found

on the City's website under the Government tab and Ward Maps page. Located on the Ward Maps page is a written description that provides boundaries of each ward.

MARK YOUR CALENDARS

Louisburg City Council
6:30 pm Monday, May 1
City Hall, 215 S. Broadway

Louisburg Park & Tree Board
6:30 pm Monday, May 8
City Hall, 215 S. Broadway

Louisburg City Council
6:30 pm Monday, May 15
City Hall, 215 S. Broadway

Louisburg Recreation Commission
6 pm Tuesday, May 16
City Hall, 215 S. Broadway

Louisburg Aquatic Center opens for the season
noon, Saturday, May 27
402 Aquatic Dr.

City Hall closed in observance of Memorial Day
Monday, May 29

Fox Hall/Cemetery Board
5 pm Tuesday, May 30
City Hall, 215 S. Broadway

Louisburg Planning Commission
6:30 pm Wednesday, May 31
City Hall, 215 S. Broadway

Louisburg City Council
6:30 pm Monday, June 5
City Hall, 215 S. Broadway

Historic Preservation Commission
6:30 pm Monday, June 7
City Hall, 215 S. Broadway

Louisburg Park & Tree Board
6:30 pm Monday, June 12
City Hall, 215 S. Broadway

Fishing Derby
7-11 am Saturday, June 17
Ron Weers Park

City Hall closed in observance of Juneteenth
Monday, June 19

Louisburg City Council
6:30 pm Tuesday, June 20
City Hall, 215 S. Broadway

Louisburg Recreation Commission
6 pm Tuesday, June 20
LRC Board office, 105 S. Fifth St. East

Louisburg Planning Commission
6:30 pm Wednesday, June 28
City Hall, 215 S. Broadway



City of Louisburg

2023 Drinking Water Consumer Confidence Report

Note: Data contained in this report is from the 2022 calendar year.

4/05/2023

Our goal is to provide a safe and dependable supply of drinking water.

The City of Louisburg Water Department and the Marais des Cygnes Public Utility Authority (MDCPUA) are pleased to present to you this year's Consumer Confidence Report. The U.S. Environmental Protection Agency requires distribution of this report. It is designed to inform you about the quality of water and services we deliver to you everyday. We want you to understand the efforts we make to continually improve the water treatment process and protect our water resources.



WATER SYSTEM

The City of Louisburg currently purchases our drinking water from another water system through a Consecutive Connection (CC). Our water comes from surface water we purchase from MDCPUA Water Treatment Plant. The MDCPUA Water Plant is a public entity jointly owned by the cities of Paola and Louisburg, Kansas. The City of Louisburg has two elevated water storage tanks located within city limits: a 750,000 gallon tank located at Harvest Drive and Wildcat Drive and a 250,000 gallon tank located at South Third Street and Metcalf Road. The MDCPUA transmission system includes a 1,100,000 gallon ground tank and two 750,000 gallon elevated tanks.

Statement of Water Quality

The City of Louisburg and MDCPUA strive to meet all Federal and State requirements through continuous monitoring and testing for water quality.

Contacting Your Water Department

If you have any questions about this report or concerning your water utility, please contact the City Administrator, Nathan Law, at City Hall, (913) 837-5371. The City of Louisburg wants you, our valued customers, to be informed about your water utility. The City conducts regularly scheduled Council meetings on the first and third Mondays of each month at 6:30 PM. If you would like to address the City Council concerning the quality of your water, you may attend any Council meeting.

Persons with Special Needs or Immune Deficiencies - Some people may be more vulnerable to contaminants in drinking water than the general population. Immuno-compromised persons such as those with cancer undergoing chemotherapy, persons who have undergone organ transplants, people with HIV/AIDS or other immune system disorders, some elderly, and infants can be particularly at risk from infections. These people should seek advice about drinking water from their health care providers. EPA/CDC guidelines on appropriate means to lessen the risk of infection by *Cryptosporidium* and other microbial contaminants are available from the Safe Drinking Water Hotline (800-426-4791).

Water Quality Monitoring

"WE ARE
COMMITTED TO
ENSURING THE
QUALITY OF
YOUR WATER"

The City of Louisburg Water Department & MDCPUA Water Plant routinely monitor for contaminants in your drinking water according to Federal and State laws. Tables No. 1 and 2 show the results of our monitoring for the period of January 1st to December 31st, 2022.

Contaminants that may be present in source water before we treat it include:

- ***Microbial contaminants**, such as viruses and bacteria, which may come from sewage treatment plants, septic systems, livestock operations and wildlife.
- ***Inorganic contaminants**, such as salts and metals, which can be naturally-occurring or result from urban storm water run-off, industrial or domestic wastewater discharges, oil and gas production, mining or farming.
- ***Pesticides and Herbicides**, which may come from a variety of sources such as storm water run-off, agriculture, and residential users.
- ***Radioactive contaminants**, which can be naturally occurring or the result of mining activity.
- ***Organic contaminants** including synthetic and volatile organic chemicals, which are by-products of industrial processes and petroleum production, and also come from gas stations, urban storm water run-off, and septic systems.

In order to ensure that tap water is safe to drink, EPA prescribes regulation which limits the amount of certain contaminants in water provided by public water systems. We treat our water according to EPA's regulations. Food and Drug Administration regulations establish limits for contaminants in bottled water, which must provide the same protection for public health.

Our water system is required to test a minimum of 6 samples per month in accordance with the Total Coliform Rule for microbiological contaminants. Coliform bacteria are usually harmless, but their presence in water can be an indication of disease-causing bacteria. When coliform bacteria are found, special follow-up tests are done to determine if harmful bacteria are present in the water supply. If this limit is exceeded, the water supplier must notify the public.

Summary of Table No. 1 and 2

Drinking water, including bottled water, may reasonably be expected to contain at least small amounts of some contaminants. The presence of contaminants does not necessarily indicate that water poses a health risk. More information about contaminants and potential health effects can be obtained by calling the EPA's Safe Drinking Water Hotline (800-426-4791).

The sources of drinking water (both tap water and bottled water) included rivers, lakes, streams, ponds, reservoirs, springs, and wells. As water travels over the surface of the land or through the ground, it dissolves naturally occurring minerals and, in some cases, radioactive material, and can pick up substances resulting from the presence of animals or from human activity.

Terms & Abbreviations

In Tables No. 1 and 2 you will find many terms and abbreviations you might not be familiar with. To help you better understand these terms we've provided the following definitions:

Maximum Contaminant Level Goal (MCLG): the "Goal" is the level of a contaminant in drinking water below which there is no known or expected risk to human health. MCLGs allow for a margin of safety.

Maximum Contaminant Level (MCL): the "Maximum Allowed" MCL is the highest level of a contaminant that is allowed in drinking water. MCLs are set as close to the MCLGs as feasible using the best available treatment technology.

Secondary Maximum Contaminant Level (SMCL): recommended level for a contaminant that is not regulated and has no MCL.

Action Level (AL): the concentration of a contaminant that, if exceeded, triggers treatment or other requirements.

Treatment Technique (TT): a required process intended to reduce levels of a contaminant in drinking water.

Maximum Residual Disinfectant Level (MRDL): the highest level of a disinfectant allowed in drinking water. There is convincing evidence that addition of a disinfectant is necessary for control of microbial contaminants.

Non-Detects (ND): lab analysis indicates that the contaminant is not present.

Parts per Million (ppm) or milligrams per liter (mg/l)

Parts per Billion (ppb) or micrograms per liter (µg/l)

Picocuries per Liter (pCi/L): a measure of the radioactivity in water.

Millirems per Year (mrem/yr): measure of radiation absorbed by the body.

Monitoring Period Average (MPA): An average of sample results obtained during a defined time frame, common examples of monitoring periods are monthly, quarterly and yearly.

Nephelometric Turbidity Unit (NTU): a measure of the clarity of water. Turbidity in excess of 5 NTU is just noticeable to the average person. Turbidity is not regulated for groundwater systems.

Running Annual Average (RAA): an average of sample results obtained over the most current 12 months and used to determine compliance with MCLs.

Locational Running Annual Average (LRAA): Average of sample analytical results for samples taken at a particular monitoring location during the previous four calendar quarters.

The following tables list all of the drinking water contaminants which were detected during the 2021 calendar year. The presence of these contaminants does not necessarily indicate the water poses a health risk. Unless noted, the data presented in this table is from the testing done January 1- December 31, 2021. The State requires us to monitor for certain contaminants less than once per year because the concentrations of these contaminants are not expected to vary significantly from year to year. Some of the data, though representative of the water quality, is more than one year old. ***The bottom line is that the water that is provided to you is safe.***

TABLE 1
 Testing Results for: City of Louisburg
 Consumer Confidence Report – 2023
 Covering Calendar Year – 2022
 PWS ID: KS2012106

This brochure is a snapshot of the quality of the water that we provided last year. Included are the details about where your water comes from, what it contains, and how it compares to Environmental Protection Agency (EPA) and State standards. We are committed to providing you with information because informed customers are our best allies. If you would like to observe the decision-making process that affect drinking water quality, please call **CRAIG HUFFERD** at 913-238-6324.

Our drinking water is supplied from another water system through a Consecutive Connection (CC). Your water comes from:

Buyer Name	Seller Name
CITY OF LOUISBURG	MIAMI CO RWD 2
CITY OF LOUISBURG	MARAIS DES CYGNES PUBLIC UTILITY AUTH

Testing Results for: CITY OF LOUISBURG

Microbiological	Result	MCL	MCLG	Typical Source
COLIFORM (TCR)	In the month of March, 1 sample(s) returned as positive	Treatment Technique Trigger	0	Naturally present in the environment

Disinfection Byproducts	Monitoring Period	Highest RAA	Range (low/high)	Unit	MCL	MCLG	Typical Source
TOTAL HALOACETIC ACIDS (HAA5)	2022	29	6.2 - 44	ppb	60	0	By-product of drinking water disinfection
TTM	2022	49	14 - 83	ppb	80	0	By-product of drinking water chlorination

Lead and Copper	Monitoring Period	90 th Percentile	Range (low/high)	Unit	AL	Sites Over AL	Typical Source
COPPER, FREE	2018 - 2020	0.075	0.012 - 0.12	ppm	1.3	0	Corrosion of household plumbing
LEAD	2018 - 2020	2.2	0 - 8	ppb	15	0	Corrosion of household plumbing

If present, elevated levels of lead can cause serious health problems, especially for pregnant women and young children. Lead in drinking water is primarily from materials and components associated with service lines and home plumbing. Your water system is responsible for providing high quality drinking water, but cannot control the variety of materials used in plumbing components. When your water has been sitting for several hours, you can minimize the potential for lead exposure by flushing your tap for 30 seconds to 2 minutes before using water for drinking or cooking. If you are concerned about lead in your water, you may wish to have your water tested. Information on lead in drinking water, testing methods, and steps you can take to minimize exposure is available from the Safe Drinking Water Hotline or at <http://www.epa.gov/safewater/lead>.

Chlorine/Chloramines Maximum Disinfection Level	MPA	MPA Units	RAA	RAA Units
2022 - 2022	3.6000	MG/L	2.4	MG/L

During the 2022 calendar year, we had the below noted violation(s) of drinking water regulations.

Compliance Period	Analyte	Comments
12/30/2020 - 6/3/2022	LEAD & COPPER RULE	LEAD CONSUMER NOTICE (LCR)

Additional Required Health Effects Language:

Some people who drink water containing trihalomethanes in excess of the MCL over many years may experience problems with their liver, kidneys, or central nervous systems, and may have an increased risk of getting cancer.

Coliforms are bacteria that are naturally present in the environment and are used as an indicator that other potentially harmful bacteria may be present. There are no additional required health effects violation notices.

Some or all of our drinking water is supplied from another water system. The table below lists all of the drinking water contaminants, which were detected during the 2022 calendar year from the water systems that we purchase drinking water from.

Regulated Contaminants	Collection Date	Water System	Highest Value	Range (low/high)	Unit	MCL	MCLG	Typical Source
ATRAZINE	5/10/2022	MARAIS DES CYGNES PUBLIC UTILITY AUTH	2.6	2.6	ppb	3	3	Runoff from herbicide used on row crops
BARIUM	5/3/2022	MIAMI CO RWD 2	0.086	0.086	ppm	2	2	Discharge from metal refineries
CHROMIUM	5/2/2022	MARAIS DES CYGNES PUBLIC UTILITY AUTH	2	2	ppb	100	100	Discharge from steel and pulp mills
FLUORIDE	1/3/2022	MARAIS DES CYGNES PUBLIC UTILITY AUTH	0.67	0.37 - 0.67	ppm	4	4	Natural deposits; Water additive which promotes strong teeth.
NITRATE	5/9/2022	MARAIS DES CYGNES PUBLIC UTILITY AUTH	1.2	0 - 1.2	ppm	10	10	Runoff from fertilizer use
SELENIUM	5/2/2022	MARAIS DES CYGNES PUBLIC UTILITY AUTH	1.5	1.5	ppb	50	50	Erosion of natural deposits

Secondary Contaminants	Collection Date	Water System	Highest Value	Range (low/high)	Unit	SMCL
ALKALINITY, TOTAL	5/3/2022	MIAMI CO RWD 2	110	110	MG/L	300
ALUMINUM	5/3/2022	MIAMI CO RWD 2	0.056	0.056	MG/L	0.05
BROMATE	8/9/2022	MARAIS DES CYGNES PUBLIC UTILITY AUTH	5.86	0 - 5.86	ppb	10
CALCIUM	5/3/2022	MIAMI CO RWD 2	44	44	MG/L	200
CHLORIDE	5/2/2022	MARAIS DES CYGNES PUBLIC UTILITY AUTH	44	44	MG/L	250
CONDUCTIVITY @ 25 C UMHOS/CM	5/2/2022	MARAIS DES CYGNES PUBLIC UTILITY AUTH	370	370	UMHO/CM	1500
CORROSIVITY	5/3/2021	MIAMI CO RWD 2	0.39	0.39	LANG	0
HARDNESS, TOTAL (AS CaCO3)	5/2/2022	MARAIS DES CYGNES PUBLIC UTILITY AUTH	140	140	MG/L	400
MAGNESIUM	5/2/2022	MARAIS DES CYGNES PUBLIC UTILITY AUTH	9.3	9.3	MG/L	150
METOLACHLOR	5/10/2022	MARAIS DES CYGNES PUBLIC UTILITY AUTH	2.4	2.4	ppb	
NICKEL	5/2/2022	MARAIS DES CYGNES PUBLIC UTILITY AUTH	0.0024	0.0024	MG/L	0.1
PH	5/2/2022	MARAIS DES CYGNES PUBLIC UTILITY AUTH	8	8	PH	8.5
POTASSIUM	5/3/2022	MIAMI CO RWD 2	4	4	MG/L	100
SILICA	5/2/2022	MARAIS DES CYGNES PUBLIC UTILITY AUTH	2	2	MG/L	50
SODIUM	5/3/2022	MIAMI CO RWD 2	25	25	MG/L	100
SULFATE	5/2/2022	MARAIS DES CYGNES PUBLIC UTILITY AUTH	29	29	MG/L	250
TDS	5/2/2022	MARAIS DES CYGNES PUBLIC UTILITY AUTH	270	270	MG/L	500
ZINC	5/3/2022	MIAMI CO RWD 2	0.019	0.019	MG/L	5

Please Note: Because of sampling schedules, results may be older than 1 year.

During the 2022 calendar year, the water systems that we purchase water from had the below noted violation(s) of drinking water regulations.

Water System	Type	Category	Analyte	Compliance Period
MIAMI CO RWD 2	MONITORING, RTN/RPT MAJOR (SWTR-FILTER)	MON	CHLORAMINE	7/1/2022 - 7/31/2022

TABLE 2
Testing Results for: MARAIS DES CYGNES PUBLIC UTILITY AUTH
Consumer Confidence Report – 2023
Covering Calendar Year – 2022
PWS ID: KS2012109

This brochure is a snapshot of the quality of the water that we provided last year. Included are the details about where your water comes from, what it contains, and how it compares to Environmental Protection Agency (EPA) and state standards. We are committed to providing you with information because informed customers are our best allies. If you would like to observe the decision-making process that affect drinking water quality, please call **MARK ALLEN** at 913-849-3146.

Your water comes from:

Source Name	Source Water Type
MARAIS DE CYGNES RIVER	Surface Water

Testing Results for: MARAIS DES CYGNES PUBLIC UTILITY AUTH

Regulated Contaminants	Collection Date	Highest Value	Range (low/high)	Unit	MCL	MCLG	Typical Source
ATRAZINE	5/10/2022	2.6	2.6	ppb	3	3	Runoff from herbicide used on row crops
BARIUM	5/2/2022	0.042	0.042	ppm	2	2	Discharge from metal refineries
CHROMIUM	5/2/2022	2	2	ppb	100	100	Discharge from steel and pulp mills
FLUORIDE	1/3/2022	0.67	0.37 - 0.67	ppm	4	4	Natural deposits; Water additive which promotes strong teeth.
NITRATE	5/9/2022	1.2	0 - 1.2	ppm	10	10	Runoff from fertilizer use
SELENIUM	5/2/2022	1.5	1.5	ppb	50	50	Erosion of natural deposits

Disinfection Byproducts	Monitoring Period	Highest RAA	Range (low/high)	Unit	MCL	MCLG	Typical Source
TOTAL HALOACETIC ACIDS (HAA5)	2022	16	16	ppb	60	0	By-product of drinking water disinfection
TTHM	2022	34	34	ppb	80	0	By-product of drinking water chlorination

Lead and Copper	Monitoring Period	90 th Percentile	Range (low/high)	Unit	AL	Sites Over AL	Typical Source
COPPER, FREE	2022	0	0.01 - 1.3	ppm	1.3	0	Corrosion of household plumbing
LEAD	2022	0	0 - 9.8	ppb	15	0	Corrosion of household plumbing

If present, elevated levels of lead can cause serious health problems, especially for pregnant women and young children. Lead in drinking water is primarily from materials and components associated with service lines and home plumbing. Your water system is responsible for providing high quality drinking water but cannot control the variety of materials used in plumbing components. When your water has been sitting for several hours, you can minimize the potential for lead exposure by flushing your tap for 30 seconds to 2 minutes before using water for drinking or cooking. If you are concerned about lead in your water, you may wish to have your water tested. Information on lead in drinking water, testing methods, and steps you can take to minimize exposure is available from the Safe Drinking Water Hotline or at <http://www.epa.gov/safewater/lead>.

Chlorine/Chloramines Maximum Disinfection Level	MPA	MPA Units	RAA	RAA Units
2022 - 2022	0.0000	MG/L		MG/L

Total Organic Carbon Lowest Month for Removal	Number of Samples	Actual Removal Ratio	Required Removal Ratio	Lowest Monthly Removal Ratio
12/1/2022 - 12/31/2022	12	2.17	1.0 RATIO	1.74

Secondary Contaminants – Non-Health Based Contaminants - No Federal Maximum Contaminant Level (MCL) Established.	Collection Date	Highest Value	Range (low/high)	Unit	SMCL
ALKALINITY, TOTAL	5/2/2022	89	89	MG/L	300
ALUMINUM	5/2/2022	0.02	0.02	MG/L	0.05
BROMATE	8/9/2022	5.86	0 - 5.86	ppb	10
CALCIUM	5/2/2022	39	39	MG/L	200
CHLORIDE	5/2/2022	44	44	MG/L	250
CONDUCTIVITY @ 25 C UMHOS/CM	5/2/2022	370	370	UMHO/CM	1500
HARDNESS, TOTAL (AS CaCO ₃)	5/2/2022	140	140	MG/L	400
MAGNESIUM	5/2/2022	9.3	9.3	MG/L	150
METOLACHLOR	5/10/2022	2.4	2.4	ppb	

NICKEL	5/2/2022	0.0024	0.0024	MG/L	0.1
PH	5/2/2022	8	8	PH	8.5
POTASSIUM	5/2/2022	3	3	MG/L	100
SILICA	5/2/2022	2	2	MG/L	50
SODIUM	5/2/2022	20	20	MG/L	100
SULFATE	5/2/2022	29	29	MG/L	250
TDS	5/2/2022	270	270	MG/L	500
ZINC	5/2/2022	0.017	0.017	MG/L	5

Please Note: Because of sampling schedules, results may be older than 1 year.

During the 2022 calendar year, we had the below noted violation(s) of drinking water regulations.

Compliance Period	Analyte	Comments
No Violations Occurred in the Calendar Year of 2022		

Additional Required Health Effects Language:

Total organic carbon (TOC) has no health effects. However, total organic carbon provides a medium for the formation of disinfection byproducts. These byproducts include trihalomethanes (THMs) and haloacetic acids (HAAs). Drinking water containing these byproducts in excess of the MCL may lead to adverse health effects, liver or kidney problems, or nervous system effects, and may lead to an increased risk of getting cancer.

There are no additional required health effects violation notices.